

F19BP Backplated Male Elbows

Scope of Use / Specification Sheet

SharkBite Max™ is a high-performance Push-To-Connect solution suitable for Copper and PEX applications.

SharkBite® is manufactured under our stringent and rigorous quality control to ensure every fitting and pipe meets the demands of real-world plumbing.

The system includes fittings suitable for PEX in 16mm, 20mm and 25mm sizes as well as fittings suitable for Copper in DN15, DN20 and DN25 sizes, offering robust versatility for new installations, maintenance and retrofit applications. Made for domestic and commercial water supply systems. Designed for licensed plumbers who value precision and reliability. It's a smart, stronger and faster way to get the job done.



FF350

Features and Benefits

- Patented technology
- Quick and easy to install in both wet and dry conditions
- No expensive tools required—no soldering, glue or joining tools
- Approved for behind the wall application
- Approved for underground installation with SharkBite® Silicone Wrap (VC870)
- Demountable, reusable and rotatable after installation
- Reinforced 304 stainless steel collar for extra strength

Product List

Order Code	WA Code	Retail Code	Description
FF350		FF350A	16mm × ½" MI, 75mm Length
FF351		FF351A	16mm × ½" MI, 185mm Length
FF352	FF352W	FF352A	16mm × ½" MI, 100mm Length
FF354		FF354A	20mm × ¾" MI, 185mm Length
FF356			20mm × ½" MI, 100mm Length
FF358			20mm × ½" MI, 200mm Length

Materials

Body	Lead Free DZR C69300
Grab Ring	316 Stainless Steel
O-Ring	EPDM
Cartridge Components	15% Glass-filled Nylon 6

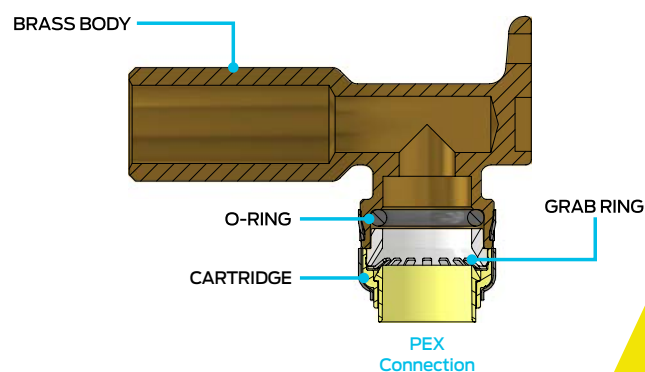

25 YEAR
GUARANTEE

All SharkBite® fittings are guaranteed against defects in materials or manufacturing for a period of 25 years from the date of purchase.

sharkbite.com.au | 1800 810 803 | sales.au@rwc.com

EPK0228 REV -

F19BP Backplated Male Elbows

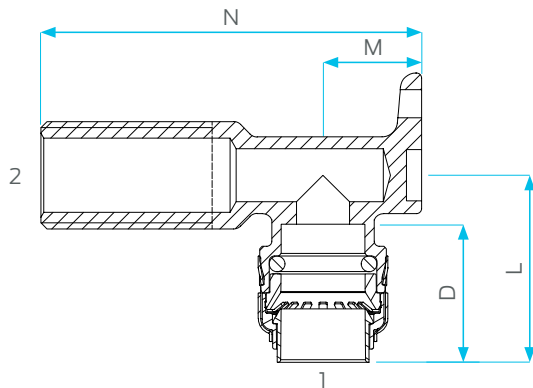

Product Dimensions

Code	1	2	D	L	M	N
FF350	16 OD	G½" MI	27	36.6	19.3	75
FF351	16 OD	G½" MI	27	39.1	19.3	185
FF352	16 OD	G½" MI	27	38.6	19.3	100
FF354	20 OD	G¾" MI	31	45.7	22	185
FF356	20 OD	G½" MI	31	40.1	22	100
FF358	20 OD	G½" MI	31	40.1	22	200

Working Pressures and Temperatures

Pipe	Ambient Temp (20°C)	Max Temp (70°C)
PEX SDR9	2000kPa	1000kPa

PEX Dimensions

Nominal Outside Diameter	16mm	20mm
Average Wall Thickness	2.2	2.5
Average Internal Diameter	11.9	15.2

Installation

Installation is subject to the requirements of the applicable regulatory authority, the National Construction Code Volume Three – Plumbing Code of Australia, associated reference standards as applicable at the time and AS/NZS 3500. This product is compliant to the Lead Free requirements of the National Construction Code Volume Three. For further Scope of Use, please visit www.sharkbite.com.au/resources.

Warranty

Reliance Worldwide Corporation (Aust.) Pty. Ltd. (RWC) will either replace or repair any defective goods where the defect arose as a result of manufacture within the warranty period. You may contact RWC at the phone number or e-mail shown below for further information or to make a claim.

Visit www.sharkbite.com.au/warranty to view the warranty statement in full and for further important information.

Standards and Approvals



Lead Free
AS/NZS 2537.2
LN02056

Note: All measurements in mm unless otherwise stated.